



## Navigation Notice No 9 of 2022 AHEP Environmental Monitoring Buoys

### C-PODs

C-POD Northern Location 57°08.215'N 002°02.200'W

C-POD Southern Location 57°07.811'N 002°02.211'W

The C-pod monitoring equipment consists of a unit lit 8 inch orange trawl float, connected to an anchor, the monitoring equipment is housed within a plastic pipe and is located on close to the seabed.

This equipment is located within the AHEP construction boundary, all associated vessels are aware of the position of the unlit trawl float.

Figure 1 Overview plan

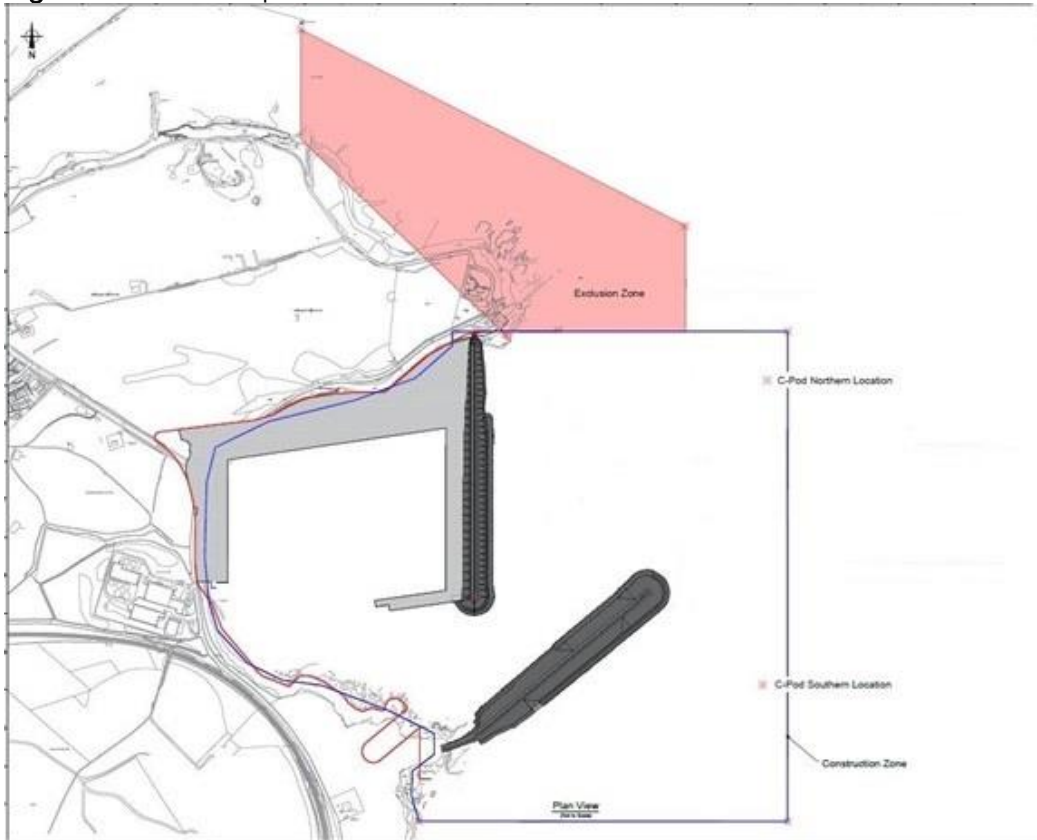

<http://www.aberdeen-harbour.co.uk/operations/information-for-port-users/navigation-notice/>

Alex McIntosh  
Harbour Master  
01/01/2022

Owners, Agents, Berth Operators etc should ensure that the contents of this Navigation Notice are made known to the Masters of their vessels.