

NOTE:-
DESIGNATED DREDGE DEPTHS SHOWN
NOT TO BE USED FOR NAVIGATION.

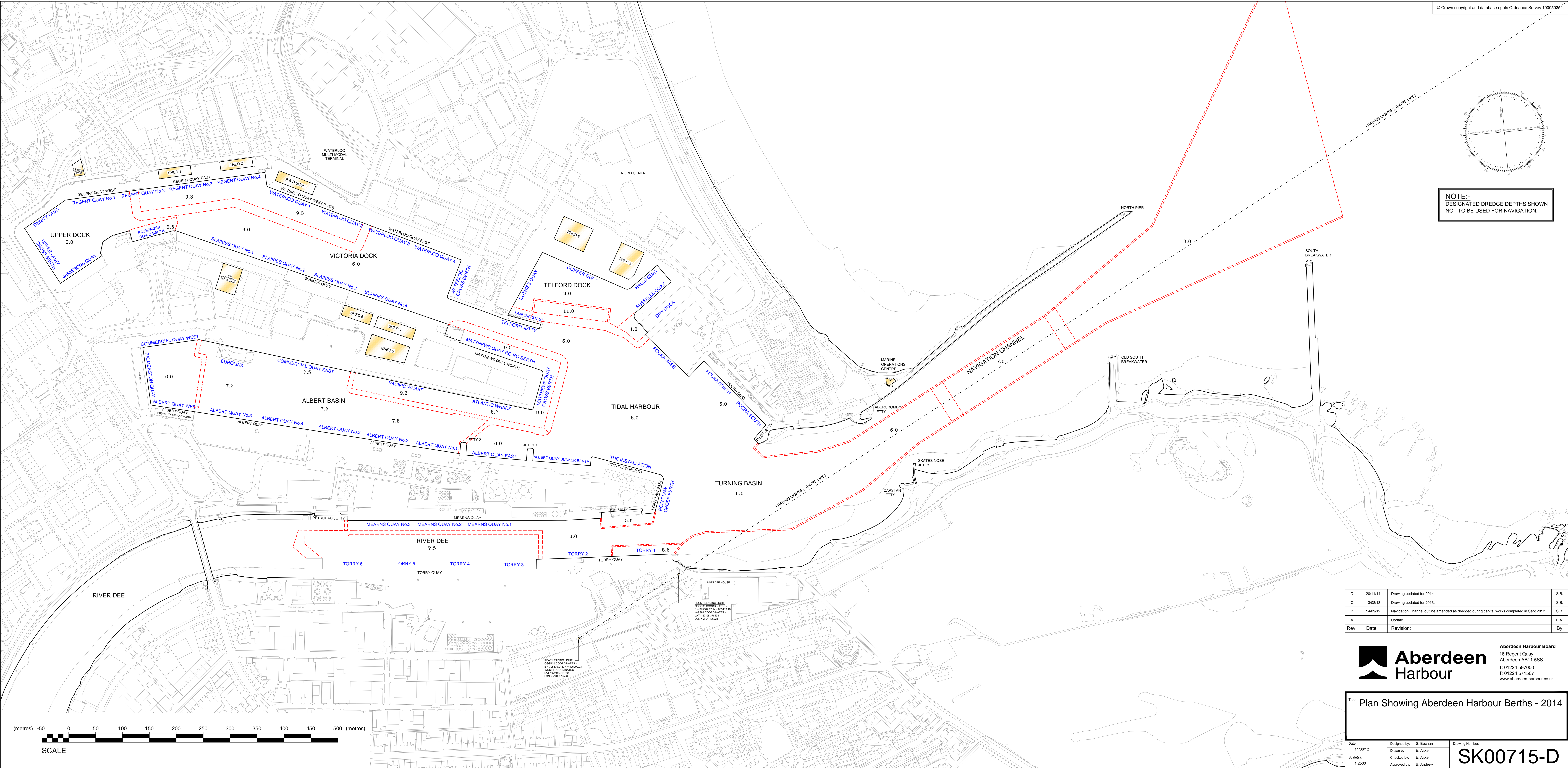

D	20/11/14	Drawing updated for 2014	S.B.
C	13/08/13	Drawing updated for 2013.	S.B.
B	14/09/12	Navigation Channel outline amended as dredged during capital works completed in Sept 2012.	S.B.
A		Update	E.A.
Rev:	Date:	Revision:	By:



Aberdeen Harbour Board
16 Regent Quay
Aberdeen AB11 5SS
t: 01224 597000
f: 01224 571507
www.aberdeen-harbour.co.uk

Title: Plan Showing Aberdeen Harbour Berths - 2014

Date:	Designed by:	Drawing Number:
11/06/12	S. Buchan	SK00715-D
Scale(s):	Drawn by:	
1:2500	E. Aitken	
	Checked by:	
	E. Aitken	
	Approved by:	
	B. Andrew	